

8 x 32 BBQ Concession Trailer

Trailer Features –

- 8' wide x 32' long BBQ Concession Trailer with 96" L aluminum tread plate porch
- Heavy duty rear and front corner post stabilizer jacks
- 2 5/16" top mount coupler
- Jack ram hoist with sand pad
- D.O.T. compliant 5/16" safety chains with Clevis safety slip hook and latch
- 8" x 3" rectangular steel tube mainrails
- Tandem 6000 LB., axles with electric brakes, E/Z lube
- ST235/80R16 load range 'D' radial tires
- Chassis fully undercoated with CPC (corrosion preventative compound)
- 8' inside height
- 1 - 36" entry door with screen, flush lock and integrated dead bolt
- Aluminum tread plate flooring
- 3/4" exterior grade plywood floor, exterior surface undercoated
- 1/4" white vinyl plywood interior sidewall liner and ceiling liner
- Ceiling and sidewalls fully insulated
- .030 prefinished white exterior aluminum
- 14" x 14" screened translucent roof vent with crank
- Two - exterior weatherproof single swivel flood light fixtures on GFI breakers located on porch
- 15 KW Onan Commercial Quiet Generator which includes a steel lined generator compartment, remote start w/hour meter, fuel compartment w/access door, 20 gallon steel fuel tank with interior fuel gauge, exterior generator access door, 100 amp deep cycle battery mounted inside compartment, charging system to charge battery while generators running
- Reverse bevertail

Equipment and Finish Features

- One - 4 section window (43" high x 97" wide) 2 stationary windows 2 vertical slider windows with screens
- One - lift up awning with gas assist awning rods w/ 16" marquee
- 12"D x 34"L laminated permanent inside counter along roadside wall
- 24"D x 76" long base cabinet with white Formica top, one inside shelf and latching cabinet doors along curbside wall
- Permanent inside overhead cabinet with self latching cabinet doors located above sink assembly - 106" long
- 50 amp, 120/240v 16 circuit service panel with 100 amp main breaker and through floor cable hatch and 50 amp manual transfer switch
- Eight - 15 amp 120v duplex wall receptacles
- One - 15 amp GFI and One - EXTERIOR 15 amp GFI, 120v duplex wall receptacle
- Four - 4' double fluorescent light fixtures with diffuser covers (bulbs not included)
- 120 Volt Interior wall switch
- One - 120v, 15000 BTU roof mounted air conditioner
- Fully enclosed NSF APPROVED stainless steel 3 compartment sink with single faucet and drain boards on each side
- Fully enclosed separate stainless steel hand sink with single faucet and divider from the 3 compartment sink
- Removable cutting board to place over the 3 compartment sink
- Heavy duty on demand water pump with on/off wall switch
- 50 gallon fresh water tank w/ external water hook up
- 6 gallon electric hot water heater
- Two - 30 gallon in frame waste water holding tank with dump valve
- NSF APPROVED 96" long commercial hood system with exhaust fan with 96" stainless back splash
- NSF APPROVED commercial stainless steel 23 cu. ft. stand up refrigerator
- NSF APPROVED commercial stainless steel 23 cu. ft. stand up freezer
- NSF APPROVED commercial stainless steel 23 cu. ft. solid door stand up heated cabinet
- NSF APPROVED commercial 2 well LP steam table (spillage pans and inserts not included)
- NSF APPROVED 18" stainless steel work top table with an adjustable underneath shelf
- Three - NSF APPROVED commercial 40 LB LP fryers with 2 baskets each
- NSF APPROVED 36" commercial LP flat top griddle
- NSF APPROVED 36" commercial stainless steel equipment stand with an adjustable underneath shelf for griddle
- NSF APPROVED commercial LP Ole Hickory Smoker with revolving racks and foot switch
- Soap dispenser
- Towel rack
- ABC fire extinguisher



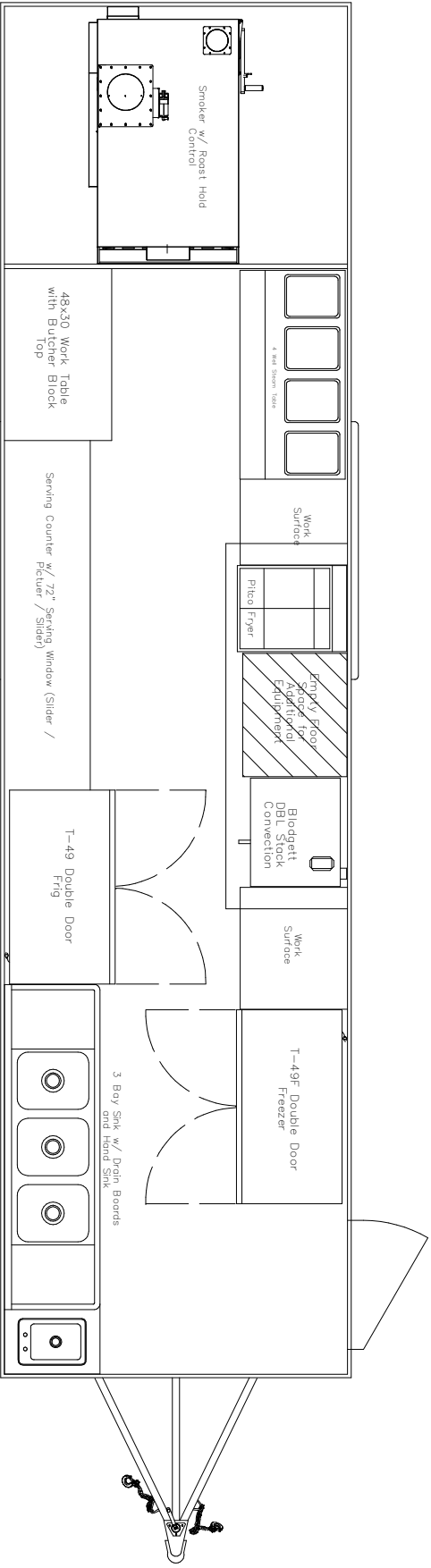

The Information is
 Proprietary to
 Trailerlogic LLC
 All Rights Reserved
 All Dimensions and
 Locations are Approximations

Title	
DWG NUMBER	0000-0000
Customer	